

Construction Plans

For

Columbia Hall Parking Renovation

In The City Of Columbia, Richland County, SC

Prepared For

University of South Carolina

743 Greene Street, Columbia, South Carolina 29208
 Telephone: (803) 777-3128

by:

Chao & Associates, Inc.

Consulting Engineers

C & A #: 398517-14



Chao & Associates, Inc.

Civil - Structural - Survey

7 Clusters Court

Columbia, SC 29210

Voice: (803) 772-8420

Fax: (803) 772-9120

Email: consult@chaoinc.com

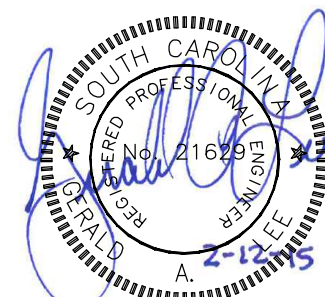

Drawing Index

- C1.0 - Existing Conditions and Demolition Plan
- C2.0 - Site Layout Plan
- C3.0 - Grading and Erosion Control Plan
- C4.0 - Construction Details

Location Map

City of Columbia
Scale: 1" = 500'



State of South Carolina
Scale: 1" = 30 Miles

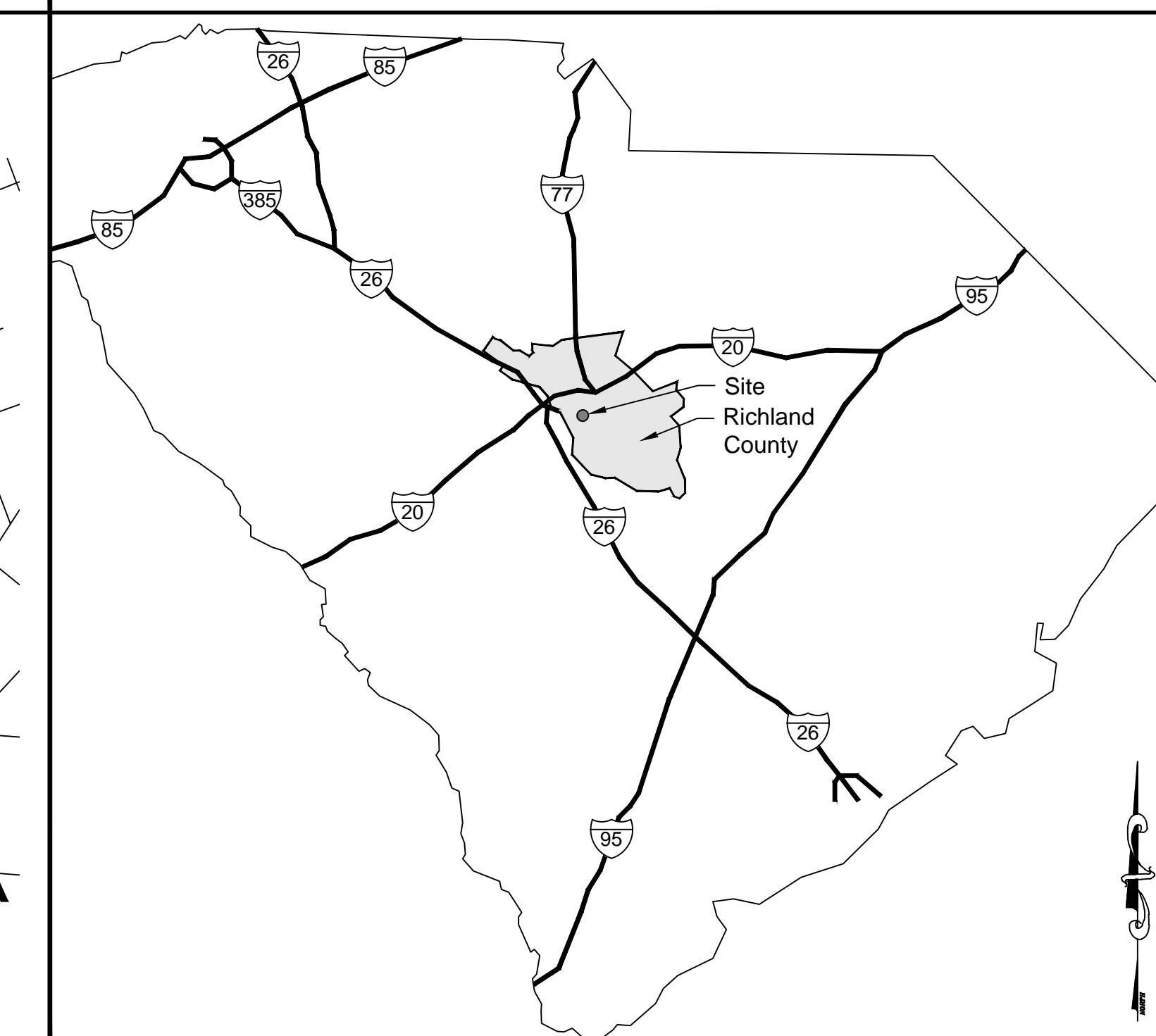

Drawing file: 398517C.dwg - Plotted: Feb. 13, 2015 - 1:49pm

3 DAYS BEFORE DIGGING IN
SOUTH CAROLINA
CALL 811
Palmetto Utility Protection Service

Notes:

1. Topographic information furnished by Chao and Associates, Inc.
2. Benchmark is based on mean sea level datum.
3. Proposed contours & proposed spot elevations represent finished grade.
4. All pavement dimensions are referenced to the face of curb, where applicable.
5. All pavement markings within City of Columbia ROW shall be installed in accordance with City of Columbia specifications.

EXISTING COLUMBIA HALL RESIDENCE BUILDING

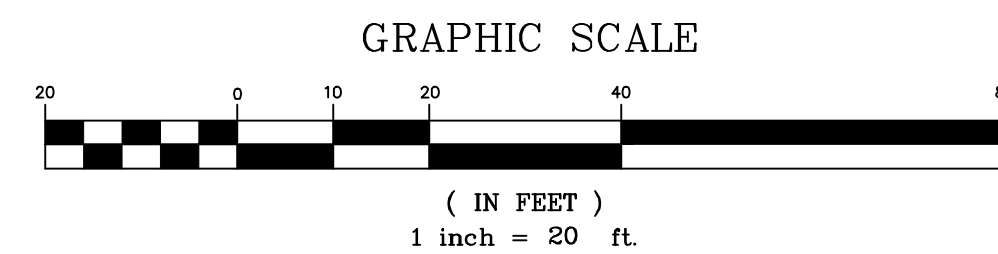
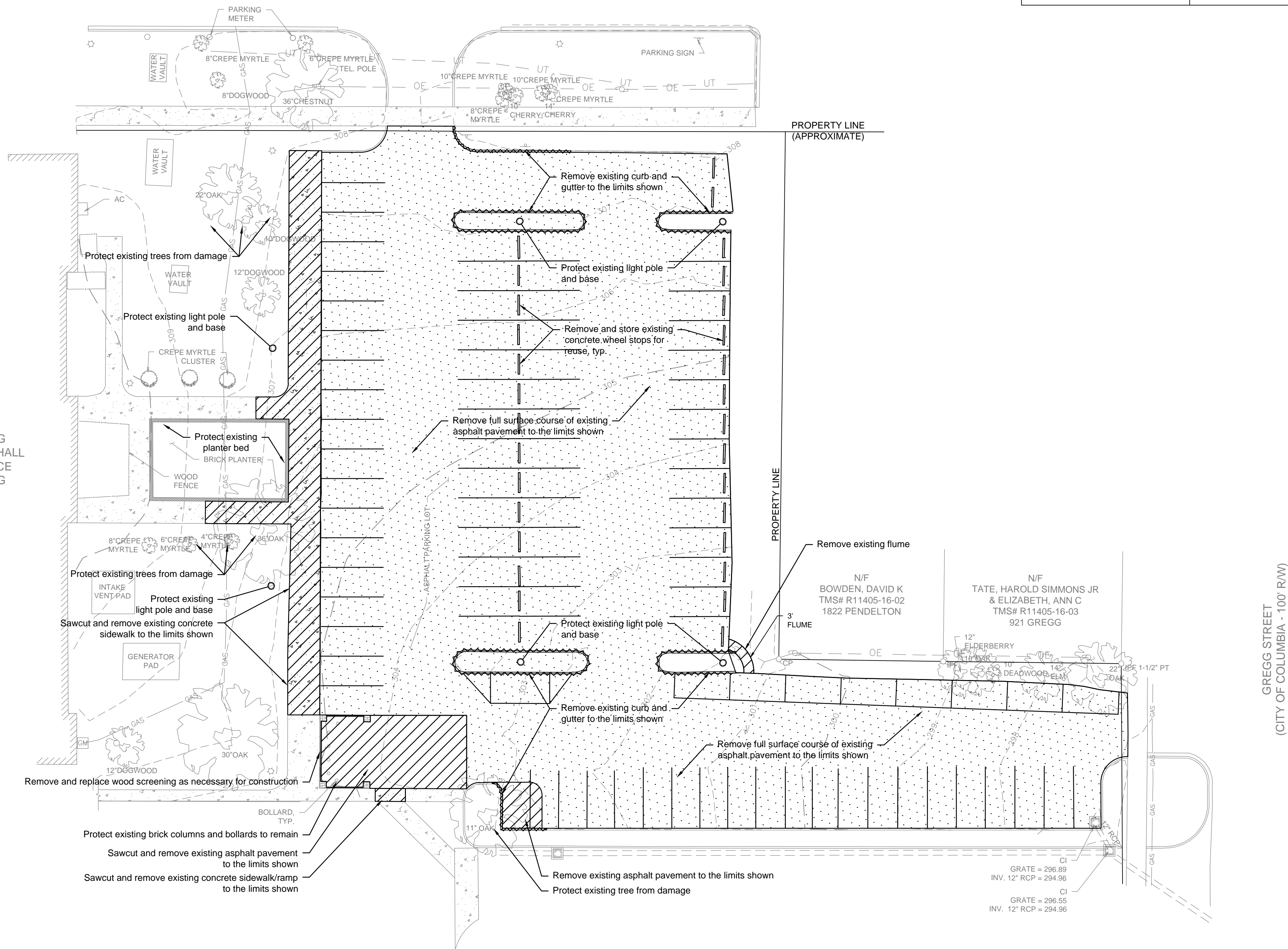

LEGEND	
	Fire hydrant
	Water valve
	Water meter
	Gas valve
	Cleanout (CO)
	Sanitary sewer manhole
	Natural gas line
	Sanitary sewer line
	Water line
	Fence line
	Overhead electric
	Underground telephone
	Underground fiber optic
	Underground cable TV
	Telephone pedestal
	Limits of disturbance
	Curb & gutter
	Junction box (JB)
	Drop inlet (DI)
	Hood & grate inlet (H&G)
	Storm drain pipe
	Heavy duty asphalt pavement
	Standard duty asphalt pavement
	Heavy duty concrete pavement
	Standard duty concrete pavement for motorcycle parking
	Concrete sidewalk
	Power pole & guy
	Light pole
	Sign

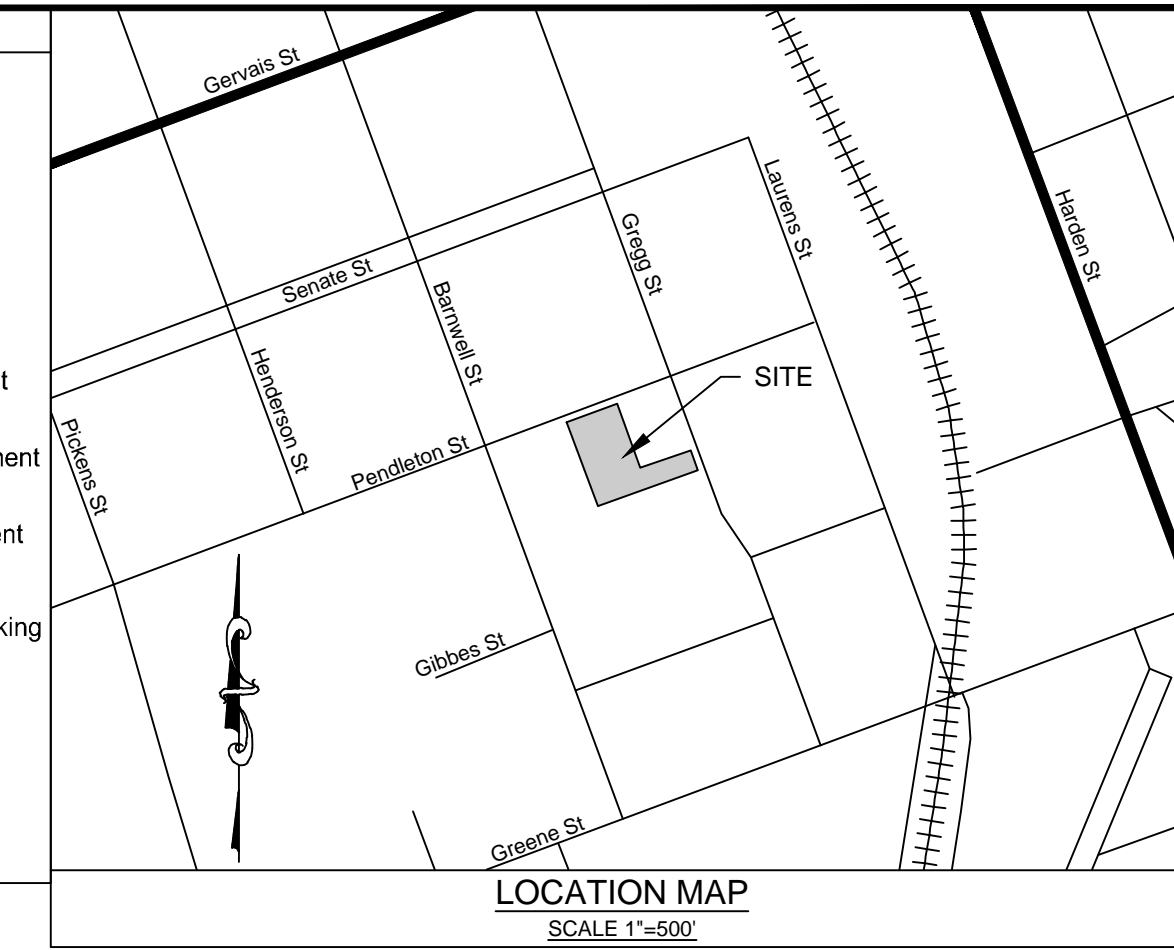

Construction notes:

1. Contractor is cautioned that the location and/or elevation of existing utilities shown herein are based on records provided by the utility company and information obtained from the field. Contractor shall verify all existing field conditions and utilities prior to beginning work.
2. Contractor is required to contact Palmetto Utility Protection Service (811) three days prior to any digging or commencing construction.
3. Provide silt fence and other erosion control devices, as may be required, to control soil erosion during construction. All disturbed areas shall be cleaned, graded and stabilized with grassing immediately after completion of construction in the area.
4. Contractor shall repair any damage caused to any existing site features to remain including, but not limited to, buildings, pavement, curb and gutter, storm drains, underground utilities, fencing, etc. in their entirety. Repairs shall be at the contractor's expense.
5. Sod shall be installed in all areas disturbed by construction that are not intended to be covered by impervious material, unless otherwise indicated.
6. If necessary, slopes which exceed four vertical feet or 4:1 slopes should be stabilized with an approved turf reinforcing mat in addition to hydroseeding. It may be necessary to install temporary slope drains during construction. Temporary berms may be needed daily until slope is brought to grade.
7. Contractor shall take necessary action to minimize the tracking of mud onto the paved roadway from construction areas. Contractor to daily remove mud/soil from pavement as required.
8. All erosion control devices shall be properly maintained during all phases of construction until the completion of all construction activities and all disturbed areas have been stabilized. Additional control devices may be required during construction in order to control erosion and/or offsite sedimentation. All temporary control devices shall be removed once construction is complete and the site is stabilized to the satisfaction of Lexington County.
9. Contractor shall abide by all provisions of the applicable city and or county storm drainage and erosion control ordinances as well as the South Carolina Sediment Reduction Act.
10. All excavation is unclassified. Excess material is to be removed from the site and disposed of in a legal manner.
11. All construction staking shall be provided at the contractor's expense.



Chao & Associates, Inc.
Civil - Structural - Survey
7 Clusters Court
Columbia, SC 29210
Voice: (803) 772-8420
Fax: (803) 772-9120
Email: consul@chaoinc.com



Existing Conditions and Demolition Plan
Columbia Hall Parking Renovation
Prepared For:
University of South Carolina
Columbia, South Carolina

Drawn: JDS
Revised:
Checked: GAL
Project No.: 398517
File: 398517C.dwg

C1.0
Sheet Number
February 12, 2015
Date

Drawing file: 398517C.dwg - Plotted: Feb. 13, 2015 - 1:48pm

3 DAYS BEFORE DIGGING IN
SOUTH CAROLINA
CALL 811
Palmetto Utility Protection Service

Notes:

1. Topographic information furnished by Chao and Associates, Inc.
2. Benchmark is based on mean sea level datum.
3. Proposed contours & proposed spot elevations represent finished grade.
4. All pavement dimensions are referenced to the face of curb, where applicable.
5. All pavement markings within City of Columbia ROW shall be installed in accordance with City of Columbia specifications.

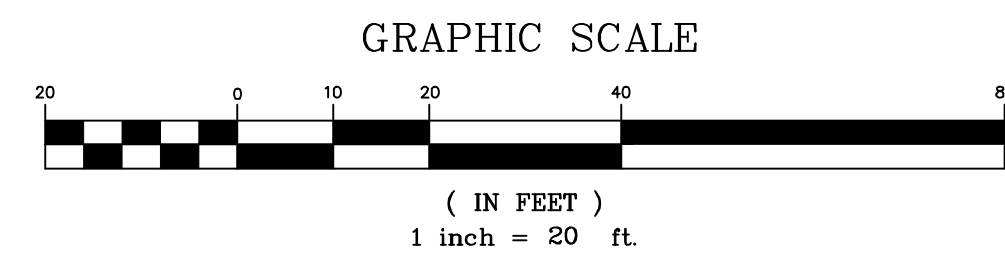
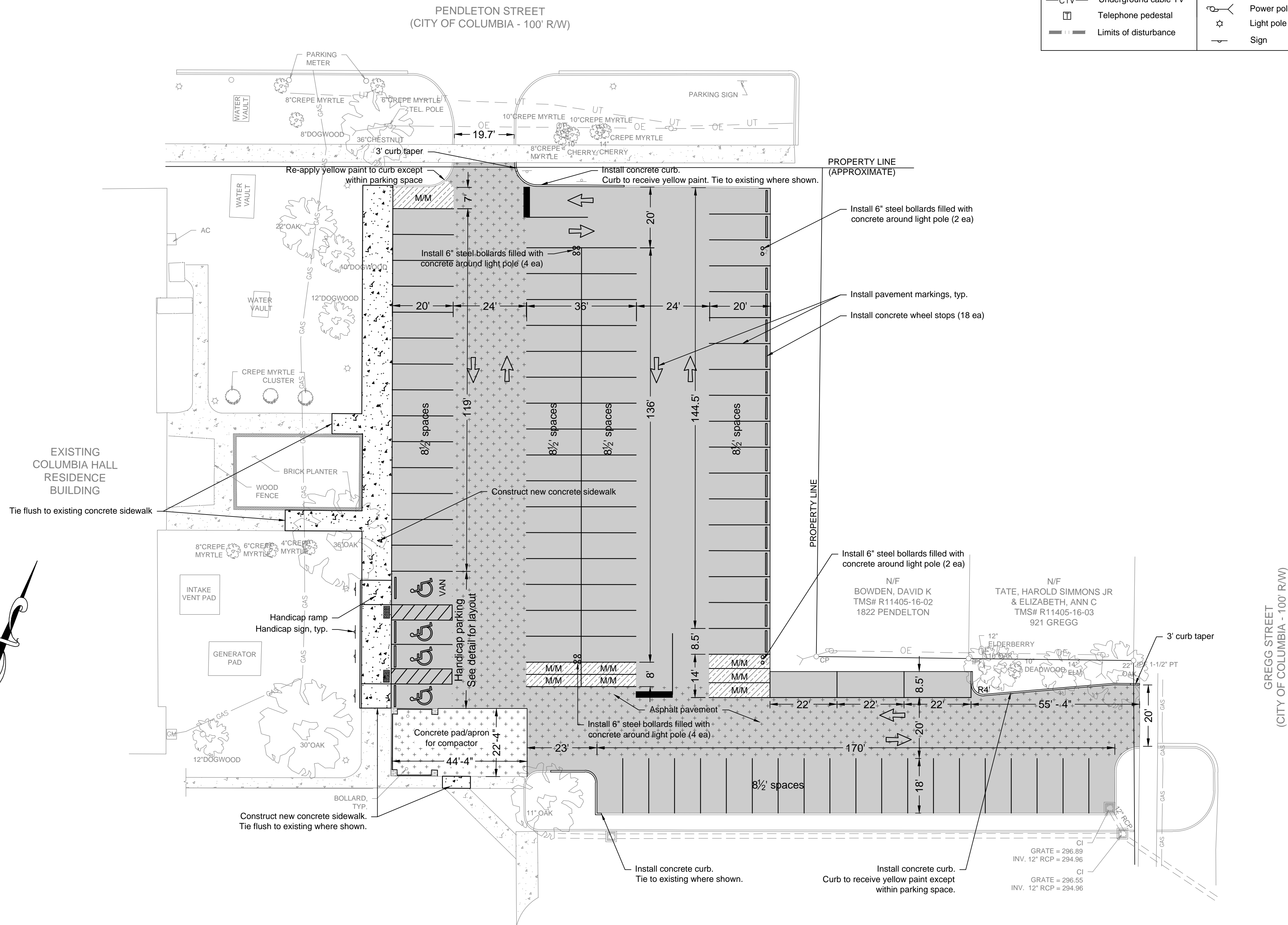

LEGEND	
	Fire hydrant
	Water valve
	Water meter
	Gas valve
	Sanitary sewer manhole
	Cleanout (CO)
	Natural gas line
	Sanitary sewer line
	Water line
	Fenceline
	Overhead electric
	Underground telephone
	Underground fiber optic
	Underground cable TV
	Telephone pedestal
	Limits of disturbance
	Curb & gutter
	Junction box (JB)
	Drop inlet (DI)
	Hood & grate inlet (H&G)
	Storm drain pipe
	Heavy duty asphalt pavement
	Standard duty asphalt pavement
	Heavy duty concrete pavement
	Standard duty concrete pavement for motorcycle parking
	Concrete sidewalk
	Power pole & guy
	Light pole
	Sign

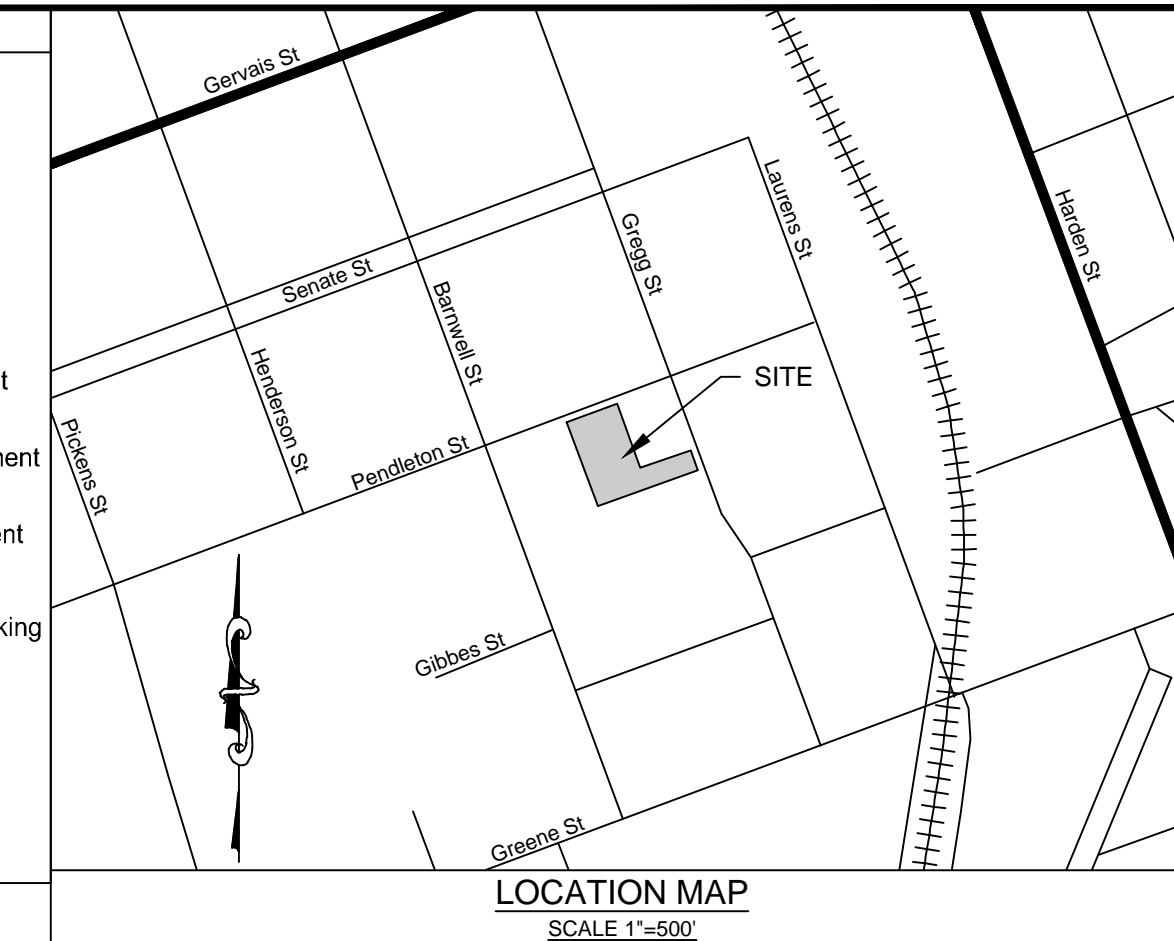

Construction notes:

1. Contractor is cautioned that the location and/or elevation of existing utilities shown herein are based on records provided by the utility company and information obtained from the field. Contractor shall verify all existing field conditions and utilities prior to beginning work.
2. Contractor is required to contact Palmetto Utility Protection Service (811) three days prior to any digging or commencing construction.
3. Provide silt fence and other erosion control devices, as may be required, to control soil erosion during construction. All disturbed areas shall be cleaned, graded and stabilized with grassing immediately after completion of construction in the area.
4. Contractor shall repair any damage caused to any existing site features to remain including, but not limited to, buildings, pavement, curb and gutter, storm drains, underground utilities, fencing, etc. in their entirety. Repairs shall be at the contractor's expense.
5. Sod shall be installed in all areas disturbed by construction that are not intended to be covered by impervious material, unless otherwise indicated.
6. If necessary, slopes which exceed four vertical feet or 4:1 slopes should be stabilized with an approved turf reinforcing mat in addition to hydroseeding. It may be necessary to install temporary slope drains during construction. Temporary berms may be needed daily until slope is brought to grade.
7. Contractor shall take necessary action to minimize the tracking of mud onto the paved roadway from construction areas. Contractor to daily remove mud/soil from pavement as required.
8. All erosion control devices shall be properly maintained during all phases of construction until the completion of all construction activities and all disturbed areas have been stabilized. Additional control devices may be required during construction in order to control erosion and/or offsite sedimentation. All temporary control devices shall be removed once construction is complete and the site is stabilized to the satisfaction of Lexington County.
9. Contractor shall abide by all provisions of the applicable city and or county storm drainage and erosion control ordinances as well as the South Carolina Sediment Reduction Act.
10. All excavation is unclassified. Excess material is to be removed from the site and disposed of in a legal manner.
11. All construction staking shall be provided at the contractor's expense.

Project Summary

Existing Parking: 93 Automobile 0 Motorcycle	Proposed Parking: 91 Automobile 8 Motorcycle
--	--

Tax map reference: Richland County, TMS No. R11405-16-01
Current zoning: C1 (Office and Institutional District - City of Columbia)

CHAO & ASSOCIATES, INC.
Civil - Structural - Survey
7 Clusters Court
Columbia, SC 29210
Voice: (803) 772-8420
Fax: (803) 772-9120
Email: consul@chaoinc.com

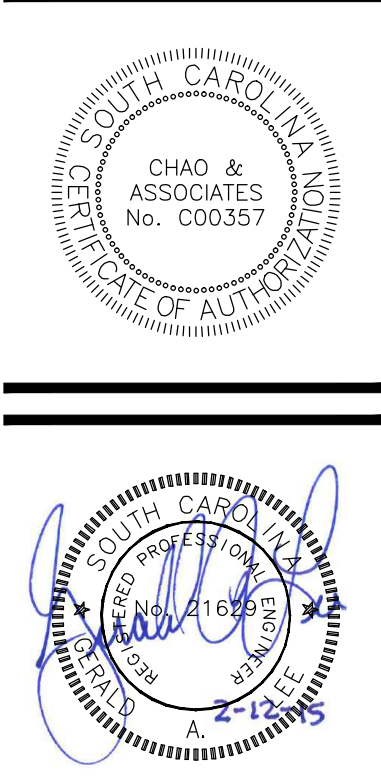

Site Layout Plan
Columbia Hall Parking Renovation
Prepared For:
University of South Carolina
Columbia, South Carolina

Drawn: JDS	Checked: GAL
Revised:	
File: 398517C.dwg	Project No.: 398517

C2.0
Sheet Number
February 12, 2015
Date

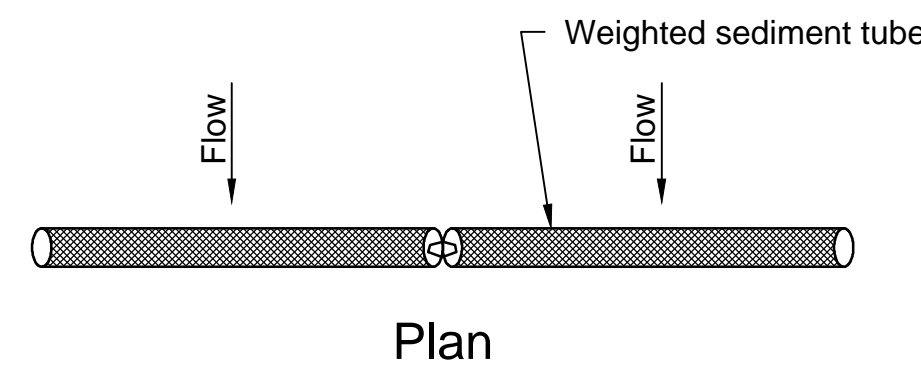

- Notes:**
- Sediment tube may be temporarily moved during construction as needed.
 - Diameter of sediment tube shall be 12 inch minimum for pavement applications.
 - Sediment tubes shall be tied together with heavy duty ties or a 12" minimum overlap shall be provided between two sediment tubes.
 - Weighted sediment tubes (12" dia.) shall have a minimum unit weight of 2 Lbs/Ft.

Weighted Sediment Tube Detail
Not to scale

LEGEND	
	Fire hydrant
	Water valve
	Water meter
	Gas valve
	Sanitary sewer manhole
	Cleanout (CO)
	Natural gas line
	Sanitary sewer line
	Water line
	Fenceline
	Overhead electric
	Underground telephone
	Underground fiber optic
	Underground cable TV
	Telephone pedestal
	Limits of disturbance
	Curb & gutter
	Junction box (JB)
	Drop inlet (DI)
	Hood & grate inlet (H&G)
	Storm drain pipe
	Heavy duty asphalt pavement
	Standard duty asphalt pavement
	Heavy duty concrete pavement
	Standard duty concrete pavement for motorcycle parking
	Concrete sidewalk
	Power pole & guy
	Light pole
	Sign

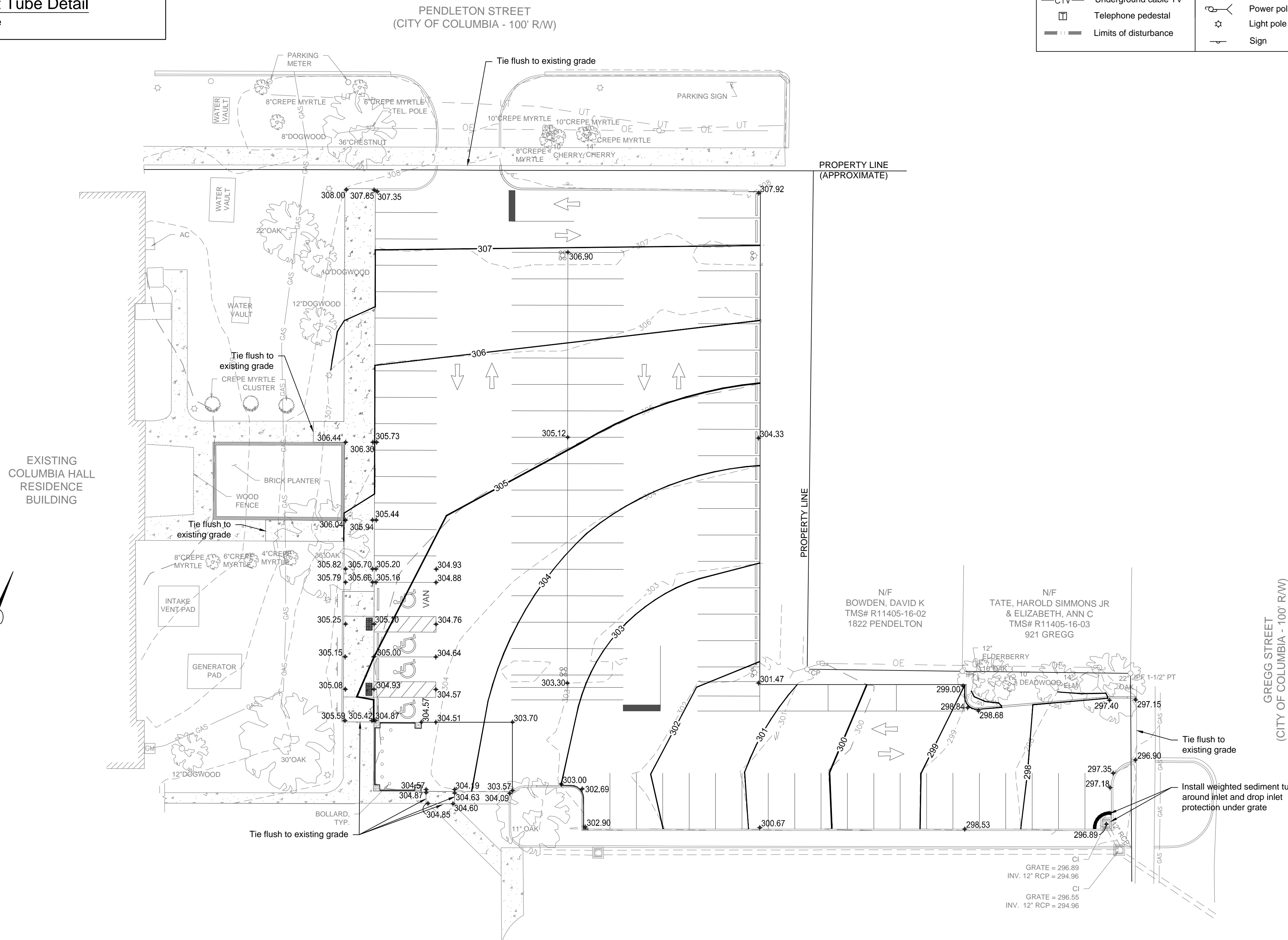
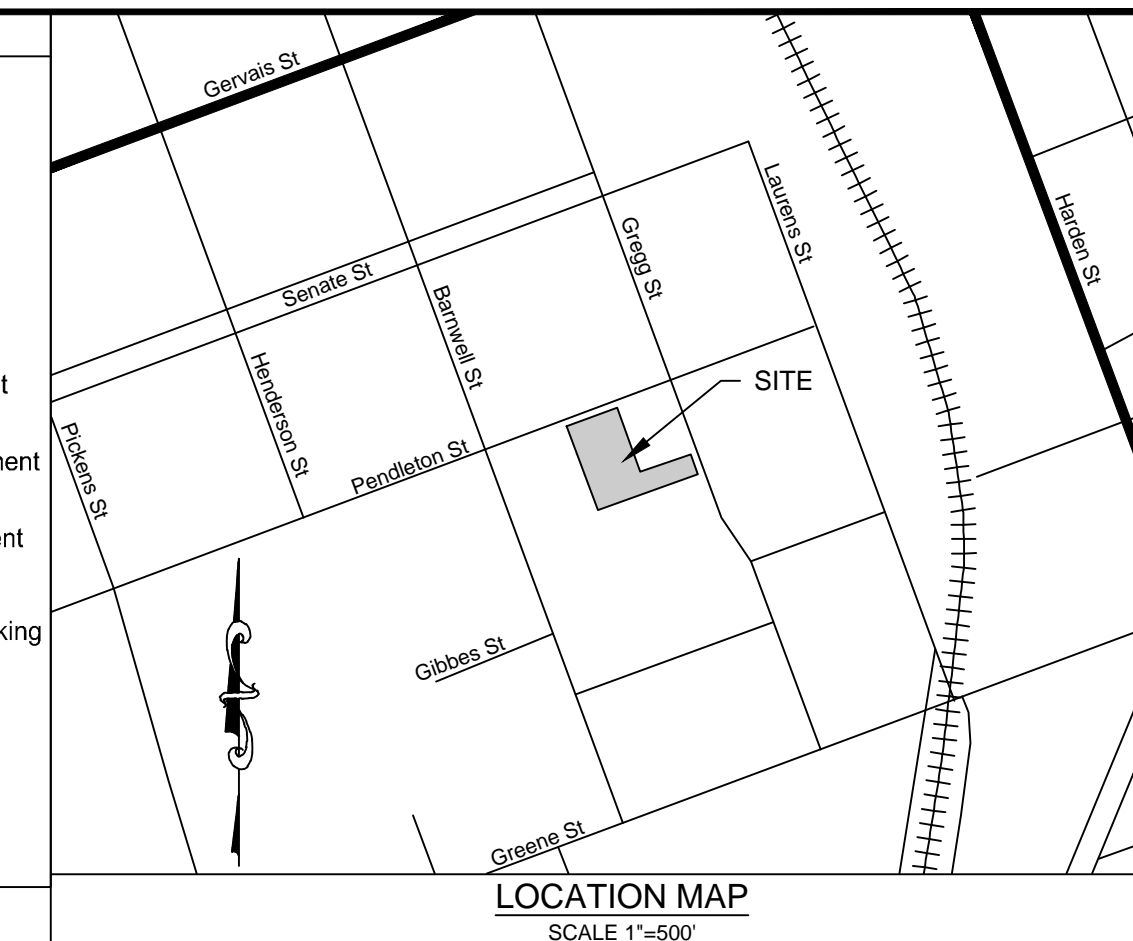

- Construction notes:**
- Contractor is cautioned that the location and/or elevation of existing utilities shown herein are based on records provided by the utility company and information obtained from the field. Contractor shall verify all existing field conditions and utilities prior to beginning work.
 - Contractor is required to contact Palmetto Utility Protection Service (811) three days prior to any digging or commencing construction.
 - Provide silt fence and other erosion control devices, as may be required, to control soil erosion during construction. All disturbed areas shall be cleaned, graded and stabilized with grassing immediately after completion of construction in the area.
 - Contractor shall repair any damage caused to any existing site features to remain including, but not limited to, buildings, pavement, curb and gutter, storm drains, underground utilities, fencing, etc. in their entirety. Repairs shall be at the contractor's expense.
 - Sod shall be installed in all areas disturbed by construction that are not intended to be covered by impervious material, unless otherwise indicated.
 - If necessary, slopes which exceed four vertical feet or 4:1 slopes should be stabilized with an approved turf reinforcing mat in addition to hydroseeding. It may be necessary to install temporary slope drains during construction. Temporary berms may be needed daily until slope is graded.
 - Contractor shall take necessary action to minimize the tracking of mud onto the paved roadway from construction areas. Contractor to daily remove mud/soil from pavement as required.
 - All erosion control devices shall be properly maintained during all phases of construction until the completion of all construction activities and all disturbed areas have been stabilized. Additional control devices may be required during construction in order to control erosion and/or offsite sedimentation. All temporary control devices shall be removed once construction is complete and the site is stabilized to the satisfaction of Lexington County.
 - Contractor shall abide by all provisions of the applicable city and or county storm drainage and erosion control ordinances as well as the South Carolina Sediment Reduction Act.
 - All excavation is unclassified. Excess material is to be removed from the site and disposed of in a legal manner.
 - All construction staking shall be provided at the contractor's expense.

Flood Certification

I hereby certify that I have consulted the National Flood Insurance Program, "Flood Insurance Rate Map", map number 45079C0094 H, panel number 94 of 275, effective date: February 20, 2002. I have determined that the above site lies within an unshaded zone "X".

Gerald A. Lee
Gerald A. Lee, P.E.
SC Reg. Professional Engineer #29169

Area of disturbance: 0.7 acres

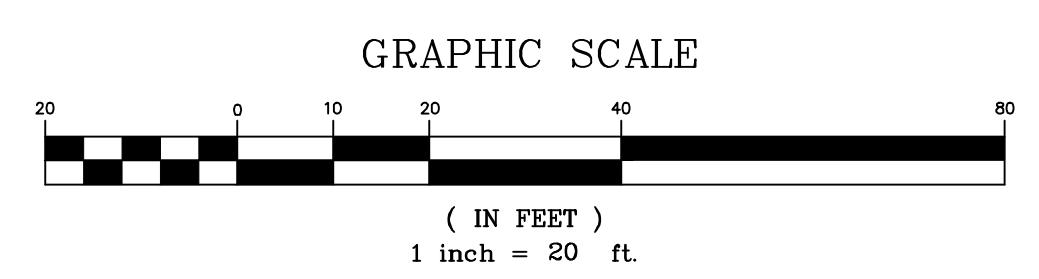

3 DAYS BEFORE DIGGING IN
SOUTH CAROLINA
CALL 811
Palmetto Utility Protection Service

- Notes:**
- Topographic information furnished by Chao and Associates, Inc.
 - Benchmark is based on mean sea level datum.
 - Proposed contours & proposed spot elevations represent finished grade.
 - All pavement dimensions are referenced to the face of curb, where applicable.
 - All pavement markings within City of Columbia ROW shall be installed in accordance with City of Columbia specifications.

CHAO & ASSOCIATES, INC.
Civil - Structural - Survey
7 Clusters Court
Columbia, SC 29210
Voice: (803) 772-8420
Fax: (803) 772-9120
Email: consul@chaoinc.com

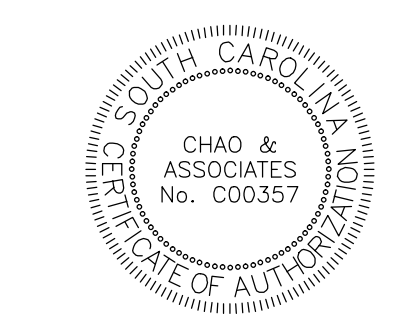

Grading and Erosion Control Plan
Columbia Hall Parking Renovation
Prepared For:
University of South Carolina
Columbia, South Carolina

Drawn: JDS
Checked: GAL
Revised:
Project No.: 398517C
File: 398517C.dwg

C3.0
Sheet Number
February 12, 2015
Date

Drawing file: 398517C.dwg - Plotted: Feb. 13, 2015 - 2:29pm

